

Standard and Dual Mode Cutting Device

Electronically power-controlled cutting depth

The **Standard Cutting Device** is used mainly in sign industry and silk screen printing. The tangentially controlled tool head with the electronic down force regulation is particularly suitable for the processing of a broad spectrum of vinyl and film material.

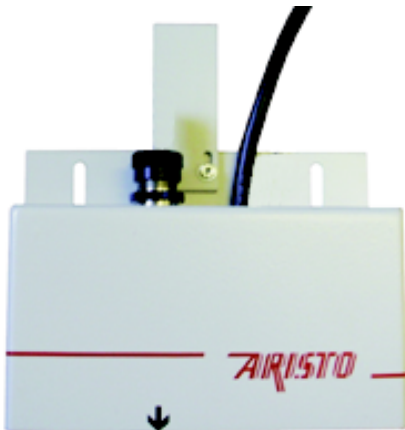

A focused precision laser beam does not only serve as guide for exact positioning of the starting point, but it can also be used for the safe PathTrac™ simulation of the cutting path, and with its assistance and the patented ARISTO Print'n'Cut procedure (included) even skewed or distorted materials can be worked on with full precision.

For those two cutting devices various blades, ball point refills and perforating needles are available. ARISTO offers different types of blades to guarantee an adjustment for optimum cutting process.

Optional pneumatic marking device to mark or label the production pieces, without tool change.



The **Dual Mode Cutting Device** is more suited for stiff material, such as laminate and glue original, which shall be kiss cut and die cut in one operation. The maximum usable cutting depth can be set directly at the tool holder. The material will be completely cut off without cutting through the fleece cover laying underneath.



Choice of material

- Sign vinyl
 - Sandblast vinyl
 - Masking films
 - Cardboard, paper
 - Nylon grips
 - Reflective sheeting
 - Metal foil (such as copper)
- and others

The material thickness depends on the processed material, max. up to approx. 1 mm.

Specifications

- tangentially control
- electronic down force regulation
- automatic tool identification
- integrated laser pointer (Print 'n' Cut System)

Tools

Different tool holders for

blades (only for Standard Cutting Device)



blades, with depth adjustment

(only for Dual Mode Cutting Device)



ball point refills (gas pressure)



Blades



16°, e.g. for masking film



35°, e.g. for standard vinyl



35°, thin, e.g. for sandblast vinyl and flock



35°, double-edged, e.g. for cardboard



16°, double-edged, e.g. for reflective vinyl

Perforating needle (only for Standard Cutting Device)



Ball point refills (gas pressure refills)



black, blue

Pneumatic Marking Device S

Installed at the tool head the pneumatic marking device works as additional tool. It is possible to mark or label the production pieces, without tool change.

Tool holders for ball point refills (gas pressure) and fibre tipped pen (LUMICOLOR 318) are available.

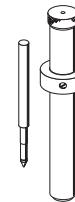
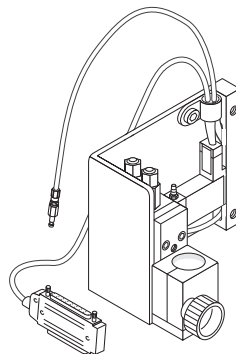

ball point refills

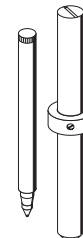

fibre tipped pen



ARISTO Graphic Systeme
GmbH & Co. KG

Schnackenburgallee 117
D-22525 Hamburg/Germany
Tel.: +49-40-547 47- 0
Fax: +49-40-547 47- 111
e-mail: sales@aristo.de
www.aristo.de

ARISTO GRAPHIC SYSTEME
Ges.m.b.H.
Jakob Prandtauer Str. 1
A-6300 Wörgl/Austria
Tel.: 0043-53 32-76 22 9-0
Fax: 0043-53 32-76 22 9-77
e-mail: info@aristographic.at

INTEGRAL TECHNOLOGIE SARL
8/10, rue du Bois Sauvage Bât i
F-91055 Evry Cedex/France
Tel.: 0033-1-64 97 81 82
Fax: 0033-1-64 97 81 66
e-mail: itcontact@integral-technologie.fr
www.aristo.fr